

SLUF UPVC Solenoid Valvea

Specification:

- 1.Body Material :UPVC
- 2.Seal material: AFLAS
- 3.Isolation structure design, keep the medium separate with the valve body and seals
- 4.Piston constructure, longer lifetime
- 5.Soft seal design, no leakage



Parameters

Code	SLUF-15	SLUF-20	SLUF-25	
Orifice (mm)	16	19.5	24	
Connection	G1/2"	G3/4"	G 1"	
Working Pressure	0.01~0.6MPa			
PIN	1.0MPa			
Body Material	UPVC			
Seal material	AFLAS			
Medium	Weak acid and alkali (Air、liquid)			
Media Temperature	MAX.+80℃			
Ambient Temperature	0~60℃			
Power	AC220V	17	17	17
	DC24V	17	17	17
Weight KG	0.80	0.82	0.85	

Construction external

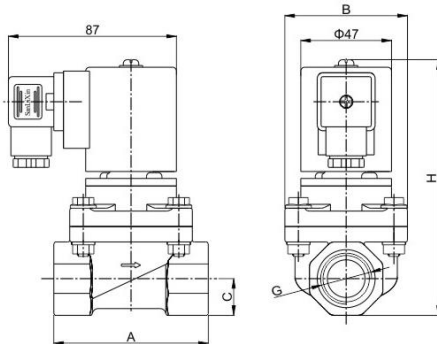

Code	Construction external				
	G	A	B	C	H
SLUF-15	G 1/2"	75	63.5	16	127
SLUF-20	G 3/4"	80	63.5	19	133
SLUF-25	G 1"	124	74	24	143

SLF PTFE Solenoid Valve

Specification and Features

1. 2 way solenoid valve
2. Body Material: PTFE
3. Diaphragm: VITON
4. Media: strong acid, strong base (alkali)
5. Mounting: flow as the arrow, Life is best
for growth level installation
6. No leakage



Parameters

Code	SLF-3	SLF-5	SLF-8	SLF-10	SLF-15	SLF-20	SLF-25
Orifice (mm)	3	5.4	8	10	16	21	27.5
Connection	M8×1	G1/4"	G3/8"		G1/2"	G3/4"	G1"
Working Pressure	0~0.2MPa	0~0.4MPa		0.01~0.6MPa			
PIN	1.0MPa						
Medium	strong acid, strong base (gas, liquid)						
Media Temperature	MAX.+180°C						
Ambient Temperature	0~60°C						
Power	AC220V	6	17	17	17	17	17
	DC24V	7	17	17	17	17	17
Weight KG	0.24	0.45	0.79	0.79	1.12	1.34	1.73

Construction, external

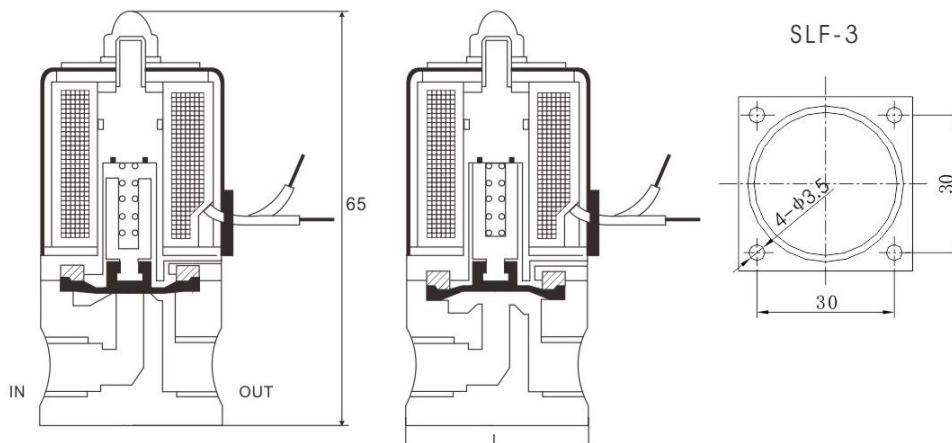

Sanlixin Solenoid Valve

SLF PTFE Solenoid Valve

Construction, external

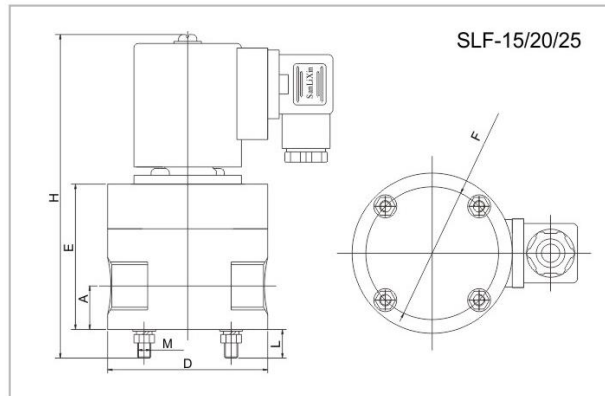
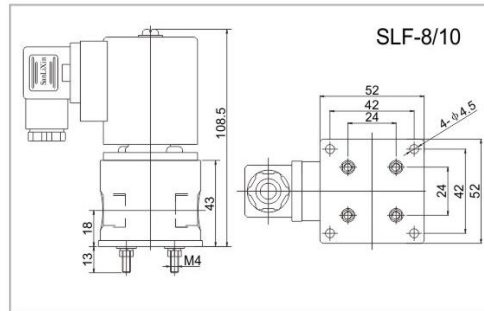
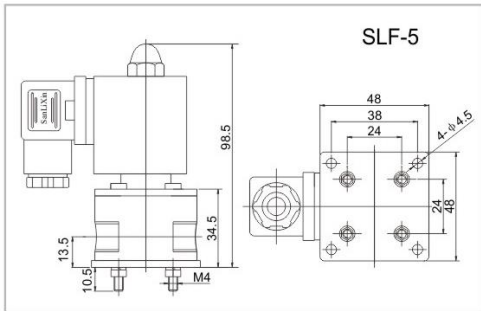

Code	Size						
	D	H	E	A	M	L	F
SLF-15	Φ70	129	63.5	19	M5	12.5	Φ58
SLF-20	Φ80	137	71	20	M6	19	Φ67
SLF-25	Φ95	148	82	29	M6	19	Φ75

Sanlixin Solenoid Valve

ZCT 2/2-Way Series Solenoid Valve • Normally Closed

Solenoid Valves Numbering System for Order

Position description	1	2	3	4	5	6	7	8	9	10
	Valve Series	Mode of Operation	Coil Type	Coil Class	Voltage	Seals Material	Body Material	Pipe Size	Orifice (φ mm)	Options
E.G.	ZCT	1	A	H	02	V	5	D	10	<input type="checkbox"/>
	ZCT Series	1: Normally Closed	A: Metallic Housing, DIN Standard D: DIN Standard Connections, Fully Encapsulated (for orifice φ 3mm only) S: NASS Coil	F:F class H:H class	02=220VAC 230VAC 50/60HZ 01=110VAC 120VAC 50/60HZ 13=DC24V 12=DC12V Contact the Company for other voltage	V: VITON T: Teflon	5=Stainless Steel 10=PMMA	A=1/8" B=1/4" B=1/4" C=3/8" C=3/8" D=1/2" D=1/2" E=3/4" G=1" A=1/8" B=1/4" C=3/8" D=1/2" D=1/2" E=3/4"	03=3.0 04=4.0 06=6.0 10=10. 15=15. 03=3.0 06=6.0 10=10. 15=15.	L: Neon Lamp N: NPT Connection

ZCT 2/2-Way Series Solenoid Valve • Normally Closed

- 1:** 2-Way normally closed solenoid valve; Closed when de-energized, open when energized.
- 2:** Body material: stainless steel and Plexiglas (standard), brass (special made)
- 3:** Max. Allowable pressure 12kgf/cm²;
Ambient Temp. 0°C~65°C (F CLASS) , 0°C~80°C (H CLASS)
- 4:** Flow as the arrow, mounts in any position;
Best position is Solenoid vertical and upright direction.
- 5:** Voltage: 220VAC/230VAC/240VAC/110VAC/24VAC 50/60HZ
24VDC/12V; Voltage Tolerance: +10% to -10% applicable voltage
- 6:** Coil can fix Germany NASS Coil, for the orifice is 3mm only,
Standard voltage: 220VAC 50/60HZ 24VDC
- 7:** This series valves are offered VITON for Seals

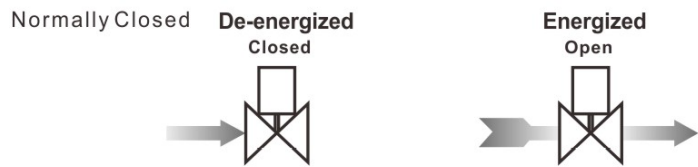

Construction, External Dimensions Chart

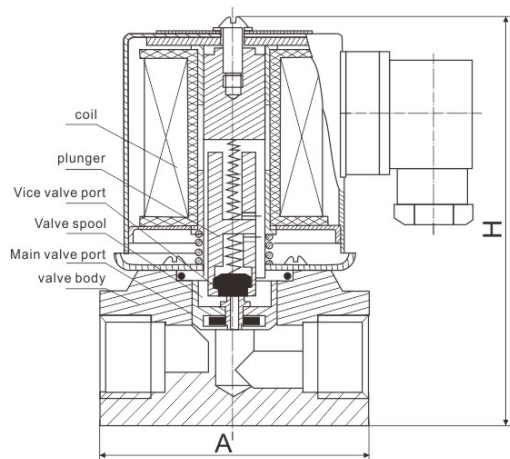

Sanlixin Solenoid Valve

ZCT 2/2-Way Series Solenoid Valve • Normally Closed

Valve Selection List

Pipe Conn- ection	Orifice mm	CV Factor	Operating pressure differential (kgf/cm ²)								Max. Fluids Temp.	Coil Type	Power consumption		Coil Class	External Dimensions Length xWidth x Height A x B x H	Model Code Follows Voltage are 220VAC 50/60HZ	Weight (KG)
			Min.	Max.									VA AC 220 V	W DC 24 V				
				Air Gas		Water Hot water Liquids		Light oil		Steam								
				AC	DC	AC	DC	AC	DC									
1/8"	3	0.23	0	13	10	13	10	10	7	3	130	D	22	13	F	36×36×82	ZCT1DF02V5A03	0.36
1/4"	3	0.23	0	13	10	13	10	10	7	3	130	D	22	13	F	36×36×82	ZCT1DF02V5B03	0.36
	4	0.6	0	7	7	7	7	5	5	3	130	D	22	13	F	50×30×82	ZCT1DF02V5B04	0.8
3/8"	4	0.6	0	7	7	7	7	5	5	3	130	D	22	13	F	50×30×82	ZCT1DF02V5C04	0.8
	6	0.9	0	6	6	6	6	6	6	5	155	A	19.8	12.5	H	50×30×82	ZCT1AH02V5C06	0.7
1/2"	6	0.9	0	6	6	6	6	6	6	5	155	A	19.8	12.5	H	50×30×82	ZCT1AH02V5D06	0.7
	10	1.5	0.1	10	10	10	10	7	7	5	155	A	19.8	22	H	70×38×110	ZCT1AH02V5D10	1.2
3/4"	15	4.5	0.1	10	10	10	10	7	7	5	155	A	19.8	22	H	80×40×115	ZCT1AH02V5E15	1.3
1"	15	4.5	0.1	10	10	10	10	7	7	5	155	A	19.8	22	H	80×40×115	ZCT1AH02V5G15	1.2

ZCT Series • 2/2-Way Plexiglas Solenoid Valve • Normally Closed

Valve Selection List

Pipe Conn- ection	Orifice mm	CV Factor	Operating pressure differential (kgf/cm ²)						Max. Fluids Temp.	Coil Type	Power consumption		Coil Class	External Dimensions Length xWidth x Height Lx W x H	Model Code Follows Voltage are 220VAC 50/60HZ	Weight (KG)
			Min.	Max.				VA AC 220 V			W DC 24 V					
				Air Gas		Water Hot water Liquids										
				AC	DC	AC	DC									
1/4"	6	0.6	0	6	6	6	6	80	D	33	32	F	50×30×82	ZCT1DF02V10B06	0.4	
3/8"	6	0.6	0	6	6	6	6	80	D	33	32	F	50×30×82	ZCT1DF02V10C06	0.4	
1/2"	6	0.6	0	6	6	6	6	80	D	33	32	F	50×30×80	ZCT1DF02V10D06	0.4	
1/2"	10	1.5	0.1	10	10	10	10	80	D	19.8	22	F	80×40×98	ZCT1DF02V10D10	0.55	
3/4"	15	4.5	0.1	10	10	10	10	80	D	19.8	22	F	80×40×98	ZCT1DF02V10E15	0.55	

JZF Series Angle Seat Valve

Application industry

Beer beverage, disinfection equipment, rubber machinery, textile printing and dyeing, pharmaceutical, medical equipment, food processing, water treatment equipment, liquid filling equipment etc

Technical parameters

Body material: SS316/SS304 Seal material: PTFE/RTFE

Orifice size: DN10-DN65

Connection type: screw thread (G、NPT) welded

Fluid medium: water、 gas or liquid, alcohol, oil, organic solvent, water vapor, weak acid or a weak base solution

Fluid temp: -10°C to $+180^{\circ}\text{C}$

Ambient temp: -10°C to $+60^{\circ}\text{C}$

viscosity: max 600CST

Control gas: air/neutral gas

Control pressure: 0.3 - 1MPa

Mounting: mounts in any position (Please select in explosive environment matching explosion-proof gas control valve)

G series (Actuator material is Aluminum alloy)



H series (Actuator material is Stainless steel)

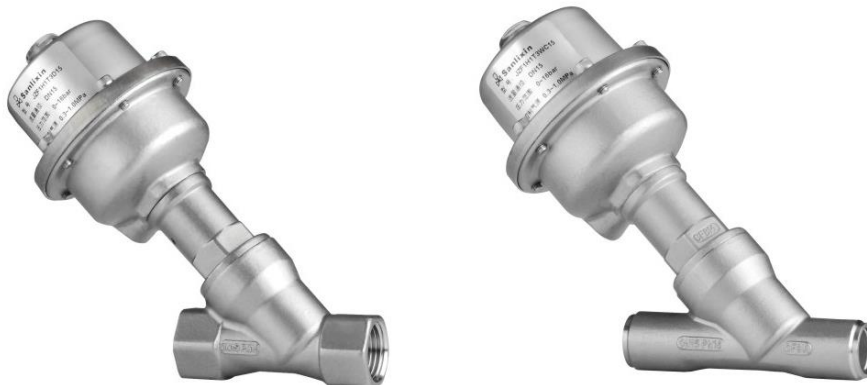

Sanlixin Solenoid Valve

JZF Series Angle Seat Valve

Angle Seat Valve Numbering System for Order

1	2	3	4	5	6	7	8	9
Valve series	Mode of Operation	Actuator material	Actuator specifications	Seal material	Body material	Connection type	Orifice size	others
JZF	1	G	1	T	3	C	10	
	1=Single acting normally closed 2=Double-acting normally closed	G: Aluminum alloy H: Stainless steel	Actuator material: Aluminum alloy 1=50 2=63 3=80 4=100 5=50 (recoil) 6=63 (recoil) 7=80 (recoil) 8=100 (recoil) Actuator material: Stainless steel 1=50 2=70 3=100 4=125 5=50 (recoil) 6=70 (recoil) 7=100 (recoil) 8=125 (recoil)	T=Teflon (normally Temp) R=RTFE (steam)	3=SS316 (normal) 4=SS304	screw thread: (normal G) C=3/8" D=1/2" E=3/4" G=1" H=1-1/4" J=1-1/2" K=2" L=2-1/2" welded: WA=ASME BPE WB=DIN11850.1 WC=DIN11850.2 WD=DIN11850.3 WE=ISO1127 /4200 WF=SMS3008 Special made need to provide pipe size	10=10.0 15=15.0 20=20.0 25=25.0 32=32.0 40=40.0 50=50.0 65=65.0	N=NPT connections

Note: welded and socket welding Angle seat valve selection, please let us know the pipe diameter and wall thickness. According to different perform equipment quality, Angle seat valve (material for aluminium alloy) and divided into G series H series for stainless steel (material)

Sanlixin Solenoid Valve

JZF Series Angle Seat Valve

Configuration dimension chart (mm)

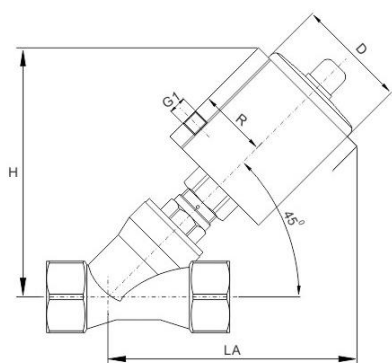

G series

size	Actuator specifications	D	R	G1	H/LA	
					screw thread	welded
DN10	50	61	38	G1/8"	127	128
DN15	50	61	38	G1/8"	127	127
DN20	50	61	38	G1/8"	130	130
DN25	50	61	38	G1/8"	136	136
	63	75	45	G1/8"	158	158
DN32	63	75	45	G1/8"	167	167
	80	94	54	G1/4"	185	185
DN40	63	75	45	G1/8"	174	174
	80	94	54	G1/4"	192	192
	100	115	64	G1/4"	212	212
DN50	63	75	45	G1/8"	185	185
	80	94	54	G1/4"	203	203
	100	115	64	G1/4"	222	222
DN65	80	94	54	G1/4"	224	224
	100	115	64	G1/4"	244	244

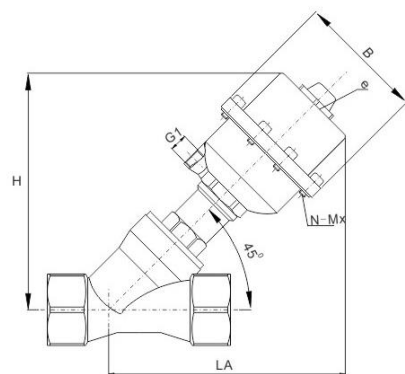

H series

size	Actuator specifications	ΦB	G1	E	N-Mx	H/LA	
						screw thread	welded
DN10	50	71	G1/8"	M16×1.5	6-M4	122	122
DN15	50	71	G1/8"	M16×1.5	6-M4	121	121
DN20	50	71	G1/8"	M16×1.5	6-M4	123	123
	70	94	G1/8"	M16×1.5	8-M5	141	141
DN25	50	71	G1/8"	M16×1.5	6-M4	130	130
	70	94	G1/8"	M16×1.5	8-M5	148	148
DN32	70	94	G1/8"	M16×1.5	8-M5	157	157
	100	132	G1/4"	M22×1.5	8-M6	192	192
DN40	70	94	G1/8"	M16×1.5	8-M5	164	164
	100	132	G1/4"	M22×1.5	8-M6	202	202
	125	160	G1/4"	M22×1.5	14-M6	228	228
DN50	70	94	G1/8"	M16×1.5	8-M5	174	174
	100	132	G1/4"	M22×1.5	8-M6	212	212
	125	160	G1/4"	M22×1.5	14-M6	288	288
DN65	100	132	G1/4"	M22×1.5	8-M6	239	239
	125	140	G1/4"	M22×1.5	14-M6	271	271

JZF Series Angle Seat Valve

screw thread type Body size (mm)

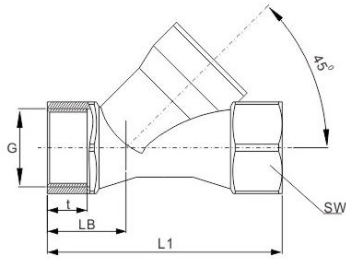

Valve body (screw thread size)					BSP	NPT	NPTF	BSPT
DN	L1	LB	SW	G	t	t	t	t
10	74	25.5	22	6-kt 3/8"	10	10.6	11.7	10.1
15	74	25.5	25	6-kt 1/2"	11.5	15.4	15.4	13.2
20	84	29	31	6-kt 3/4"	14	14.3	15.9	14.5
25	100	33.5	39	6-kt 1"	15	17	19	16.8
32	112	36	50	6-kt 1-1/4"	18	17.5	19.5	19.1
40	126	41	56	6-kt 1-1/2"	18	17.5	19.5	19.1
50	146	46	68	6-kt 2"	22	18	19.9	23.4
65	196	61	85	6-kt 2-1/2"	25	24	30	26.7

welded type Body size (mm)

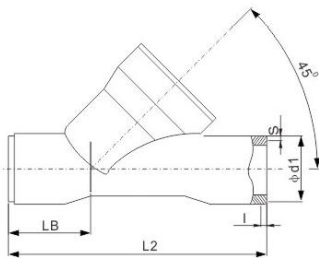

DN	L2	LB	ISO1127/4200			DIN11850.1			DIN11850.2			DIN11850.3		
			l	d1	s	l	d1	s	l	d1	s	l	d1	s
10	70	22	2	17.2	1.6	2	12	1	2	13	1.5	2	14	2
15	88	30	2	21.3	1.6	2	18	1	2	19	1.5	2	20	2
20	92	30	2.5	26.9	1.6	2.5	22	1	2.5	23	1.5	2.5	24	2
25	110	35	3	33.7	2	3	28	1	3	29	1.5	3	30	2
32	126	39	3	42.4	2	3	34	1	3	35	1.5	3	36	2
40	144	46	3	48.3	2	3	40	1	3	41	1.5	3	42	2
50	166	48	3	60.3	2	3	52	1	3	53	1.5	3	54	2
65	208	60	3	76.1	2				3	70	2			

DN	L2	LB	SMS 3008			ASME BPE			ORIFICE
			l	d1	s	l	d1	s	
15	70	22	2.5	12	1	2.5	12.7	1.65	DN10
20	88	30	2	18	1	2	19.05	1.65	DN15
25	92	30	2.5	25	1.2	2.5	25.4	1.65	DN20
40	126	39	3	38	1.2	3	38.1	1.65	DN32
50	144	46	3	51	1.2	3	50.8	1.65	DN40
65	166	48	3	63.5	1.6	3	63.5	1.65	DN50
80	208	60	3	76.1	1.6	3	76.2	1.65	DN65